

NOTES:
 SEE DRAWING SD-6 FOR NOTES 1 THROUGH 20.
 21. TOP OF EXISTING STEEL EL 21.54 UNO.
 22. DEMOLISH EXST PILE CAPS AND PILES ABOVE ELEVATION 10.00 (EXST DWGS NOT AVAILABLE)

LEGEND:
 [Hatched Box] INDICATES DEMOLISH ELEMENTS. SCALE OF HATCH MAY VARY TO DIFFERENTIATE BETWEEN DEMOLITION OF LARGER AND SMALLER ELEMENTS.

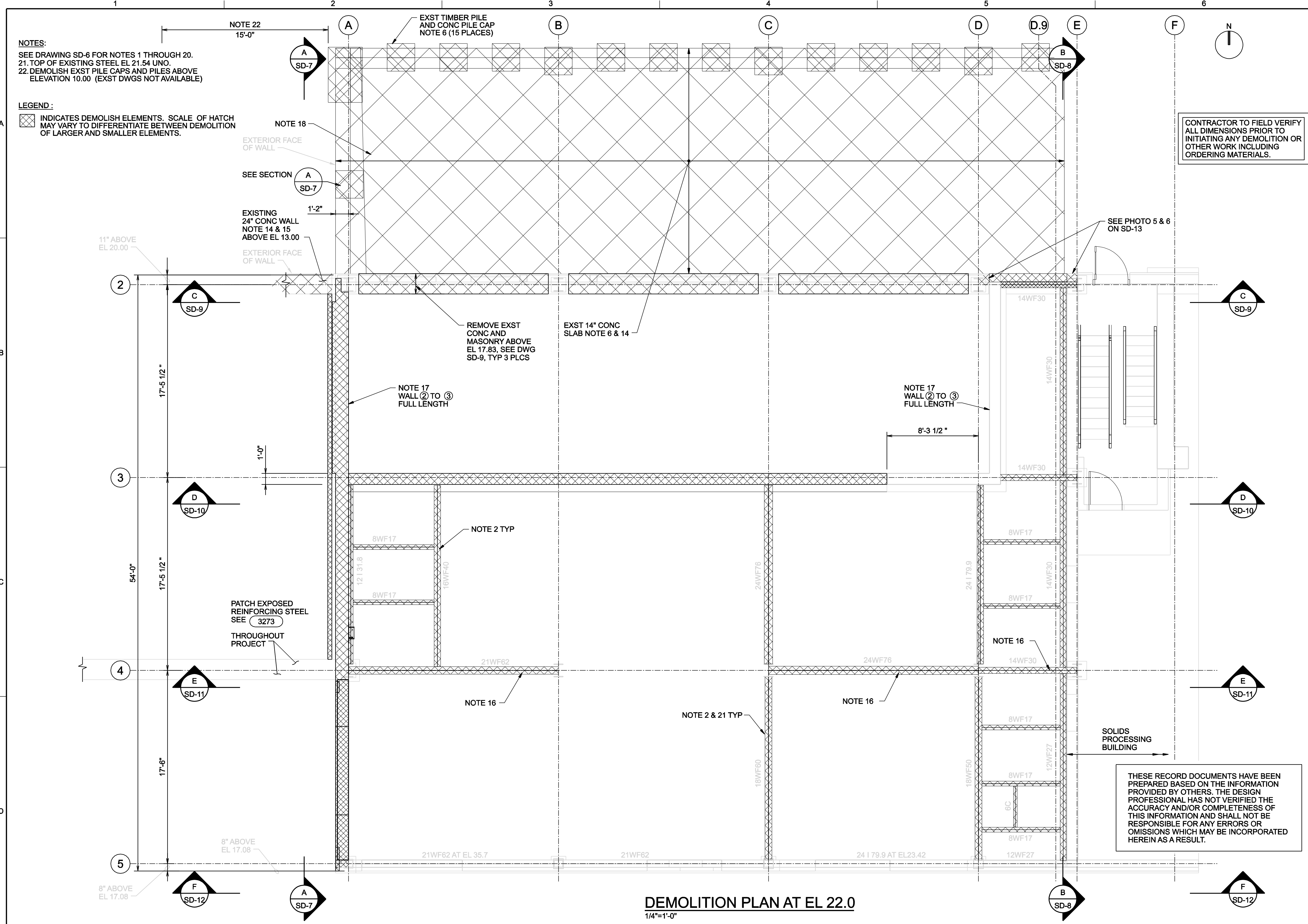

CONTRACTOR TO FIELD VERIFY ALL DIMENSIONS PRIOR TO INITIATING ANY DEMOLITION OR OTHER WORK INCLUDING ORDERING MATERIALS.

THESE RECORD DOCUMENTS HAVE BEEN PREPARED BASED ON THE INFORMATION PROVIDED BY OTHERS. THE DESIGN PROFESSIONAL HAS NOT VERIFIED THE ACCURACY AND/OR COMPLETENESS OF THIS INFORMATION AND SHALL NOT BE RESPONSIBLE FOR ANY ERRORS OR OMISSIONS WHICH MAY BE INCORPORATED HEREIN AS A RESULT.

DEMOLITION PLAN AT EL 22.0
 1/4"=1'-0"

STAMFORD WATER POLLUTION CONTROL AUTHORITY SOLIDS DRYING PROJECT		STRUCTURAL DEMOLITION PLAN AT LEVEL 22.0	
RECORD DRAWING RE-ISSUED FOR CONSTRUCTION ISSUED FOR CONSTRUCTION FOR FINAL REVIEW/ BUILDING PERMIT	01/20/08 09/08/06 07/04/06 06/19/06	NO. DATE 3 01/20/08 2 09/08/06 1 07/04/06 0 06/19/06	DR M. CHEZANOWSKI A. CHADHA M. GOODSON B. GACKSTATTER
VERIFY SCALE BAR IS ONE INCH ON ORIGINAL DRAWING.		DATE JUNE 2006 PROJ 334058 DWG SD-4 SHEET S3	