

INSTALLATION NOTES:

1. EQUIPMENT CONNECTION JOINTS TO BE GASKETED.
2. GASKETS & HARDWARE PROVIDED BY ANDRITZ.
3. CONTRACTOR TO PROVIDE FILED DIMENSIONS REQUIRED FOR CHUTES AFTER EQUIPMENT IS INSTALLED.

TAG EQP'T 40.004.000

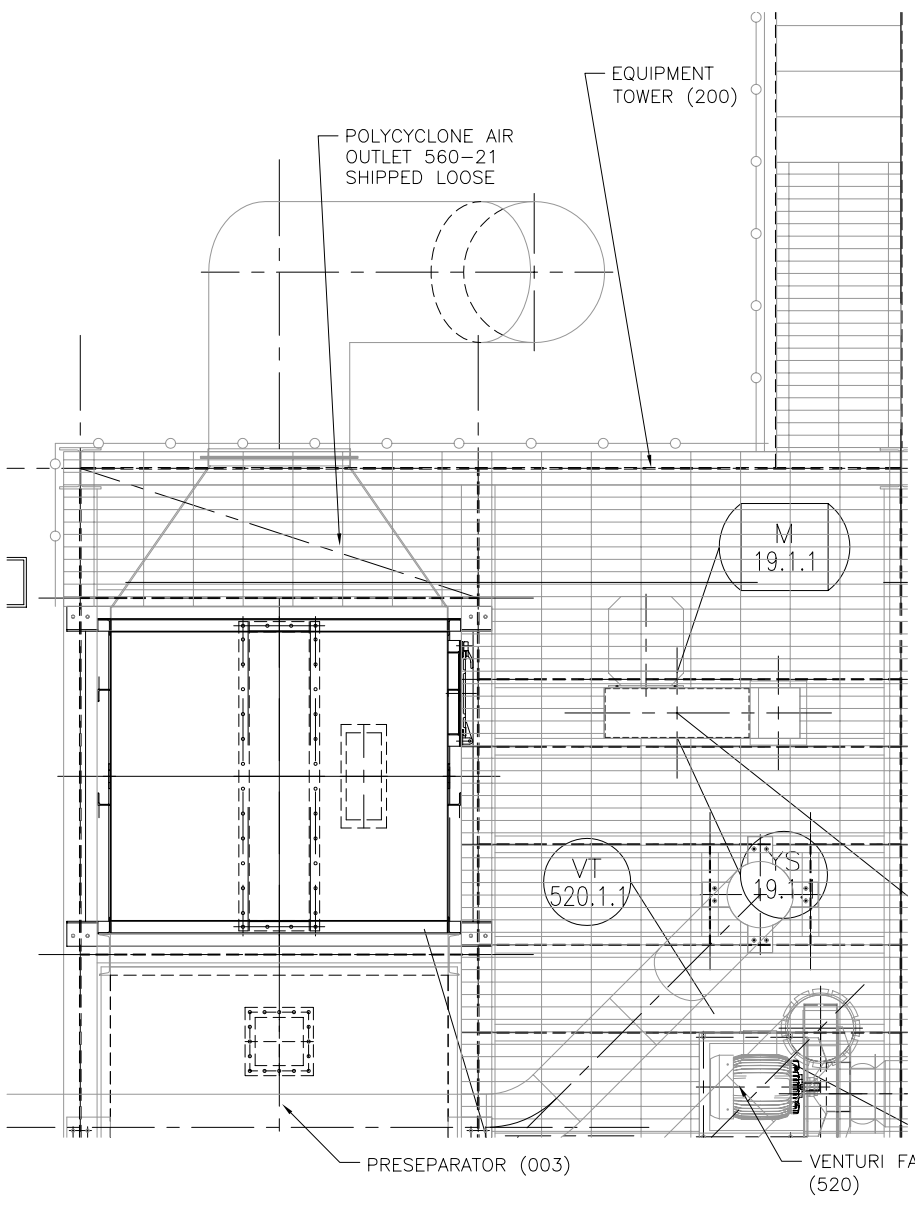

PLAN VIEW

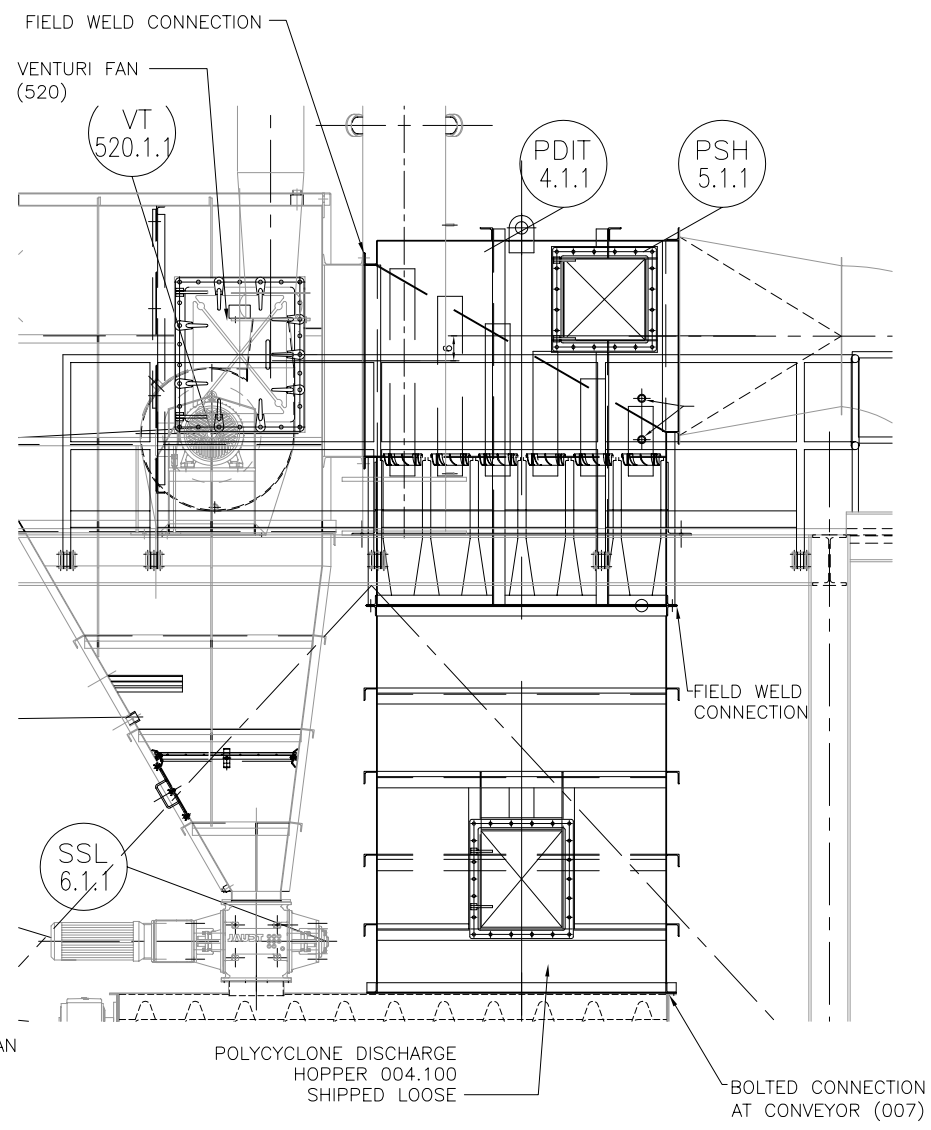

ELEVATION VIEW

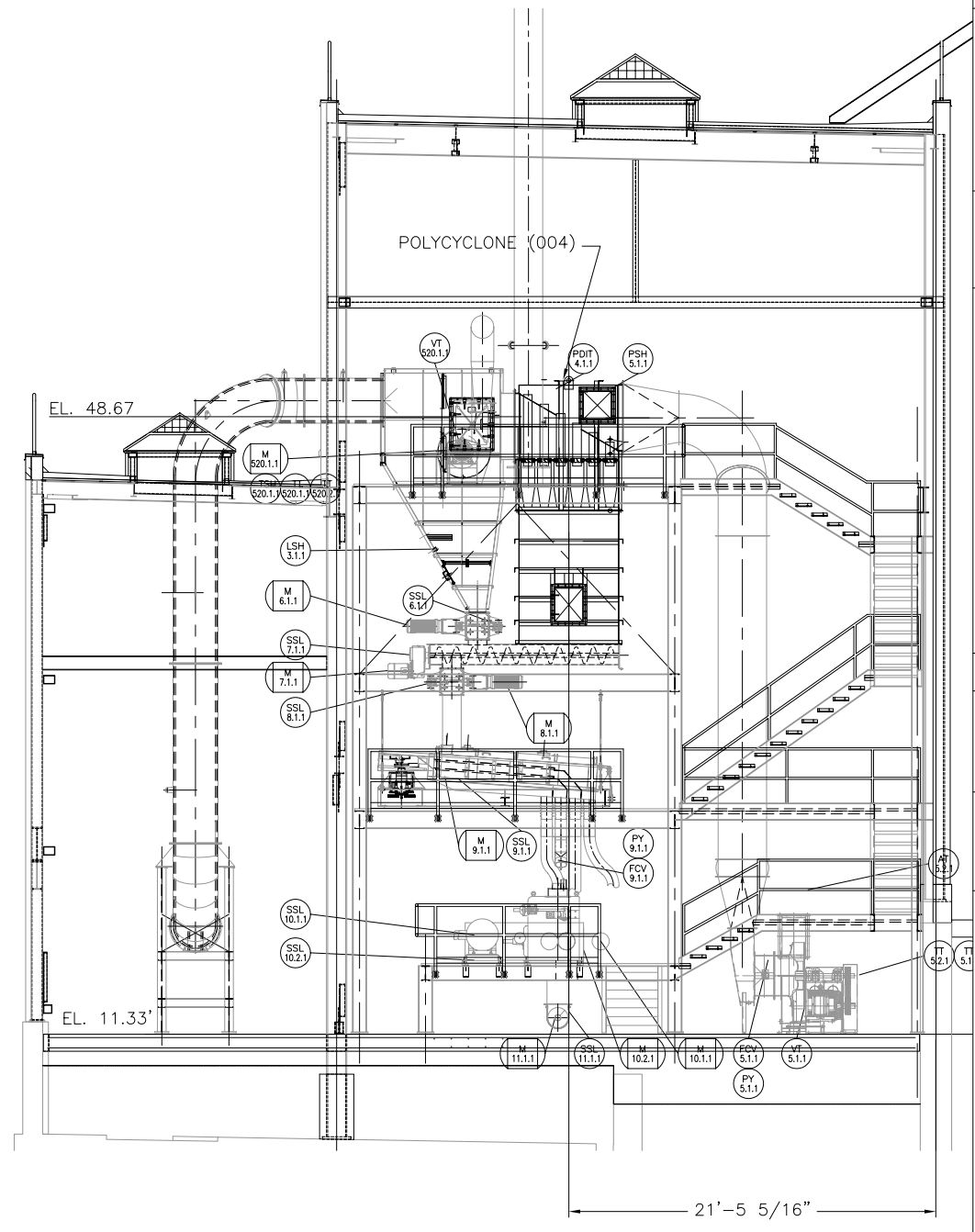

ELEVATION VIEW

SCALE: 3/16"=1'-0"

THIS DRAWING IS A TRADE SECRET AND ONLY ENTRUSTED TO THE RECEIVER FOR HIS PERSONAL USE WITHOUT THE SIGNED WRITTEN CONSENT OF ANDRITZ-RUTHNER, INC. IT MUST NOT BE COPIED NOR MADE AVAILABLE TO THIRD PARTIES, INCLUDING COMPETITORS, NOR MADE ACCESSIBLE TO SUCH PARTIES. ANY ILLEGAL USE BY THE RECEIVER OR THIRD PARTIES FOR WHICH HE IS RESPONSIBLE CAN CONSTITUTE A CAUSE FOR LEGAL ACTION. THIS DRAWING MUST BE RETURNED ON REQUEST OF THE COMPANY.

DATE:	12/19/05	REV	0
DRAWN BY:	JEN	REV	1
CHECKED BY:		DATE:	01/16/07
APPROVED BY:		DATE:	06/05/06
SCALE:	1/2"=1'-0"	FILE:	152400420
SIZE:		TITLE:	DD540
JOB NAME:		CITY OF STAMFORD CONNECTICUT SOLIDS DRYING PROJECT	
PROJECT NUMBER:		1524	
DRAWING NUMBER:		004-20	
SHEET:		1 OF 1	